



Date: Sept 13 2023 **Author:** Manveer Dhaliwal 604-444-3732 ext.141 BCCSA #: SRN1840 **Project:** NW 2880943
The Universal Group: 9770 199A St, Langley City, BC V1M 2X7 **Office:** 604-444-3732 **Fig:** 7.8
Dwg: 001

Comments:

TELUS/LTS/LITS ACCESS
SHANE BELFRY 778-870-9562

City of Chilliwack
Job location: 10370 Gillanders Rd
Closure description: Northbound lane closure, single lane alternating
Job description: Pole access
Tentative date and hours: TBD
Traffic Plan based on a 50 km/h speed zone
Traffic specifications based on the Traffic Management Manual for Work on Roadways 2020

- Notes:**
- Plan was prepared in accordance with Moti TMM 2020, and WCB Part 18
 - If a traffic control person(s) is present at the time of creation. Client has been notified of the Part 18 amendment & it is their responsibility to ensure site compliance.
 - Plan must be reviewed if there are any changes to the findings of risk assessment (provided), or after one year. Whichever, occurs first.
 - Should the escape route illustrated become no longer safe, the traffic control onsite to note change in position on FLRA.
 - Implementation of set up to follow the process outlined in the SJP-019 Device Installation Safe Job Procedure.
 - Advanced Warning Sign distances may be shortened due to urban block length.
 - 3.2m lane width to be maintained.
 - TCP to assist construction vehicles ingress/ egress.
 - TCP to identify & illustrate escape route once on site.
 - Closure to move northbound one span.



1
Cyan hatched area depicts TCPr location and escape route. Photo above depicts TCPr location and escape route



2
Cyan hatched area depicts TCPr location and escape route. Photo above depicts TCPr location and escape route

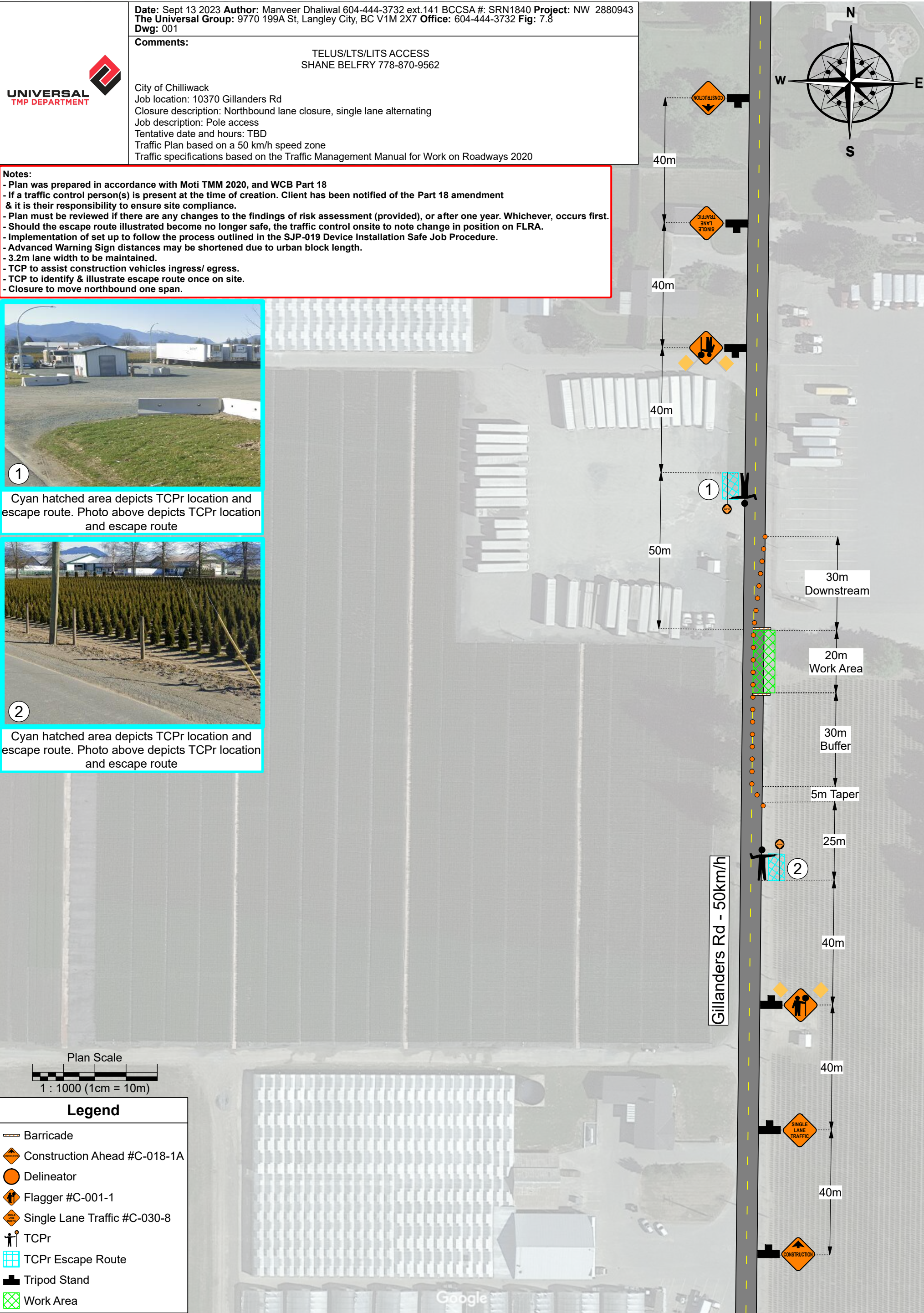

Legend	
	Barricade
	Construction Ahead #C-018-1A
	Delineator
	Flagger #C-001-1
	Single Lane Traffic #C-030-8
	TCPr
	TCPr Escape Route
	Tripod Stand
	Work Area